

2024 PRPS

RiDE the TiDE to PRPS

CONFERENCE & EXPO

Seven Springs Mountain Resort – Seven Springs, PA

March
12th-15th

EXHIBIT PACKAGES & ADVERTISING

EXPO HALL SCHEDULE

Tuesday, March 12

10:00 am - 2:30 pm Expo Hall Set up

2:30 pm - 3:30 pm Exhibitor Welcome Lunch

3:45 pm - 6:30 pm Expo Hall Opening & Reception*

6:30 pm - Keynote Drew Murray

7:30 pm - Dinner

9:00 pm - 11:00 pm Social

****Dedicated Expo Hall Hours***

Wednesday, March 13

6:30 am - 8:00 am Breakfast

9:15 am - 12:00 pm Expo Hall Open w/ Refreshments*

12:00 pm - 1:00 pm Exhibitor Appreciation Lunch

1:00 pm - 2:30 pm Expo Hall Closing Reception*

2:30 pm - 5:00 pm Expo Hall Teardown

EXPO HALL HIGHLIGHTS:

- Interact with over 400 parks, recreation and conservation professionals and volunteers.
- Share in-depth information and demonstrations of your products and services.
- Network with attendees, including purchasing agents and decision-makers.
- 6 Hours of dedicated Expo Hall time!
- Participate in educational sessions, keynote, meals, and socials – included in your package!
- Receive a list of 2024 conference attendees including email addresses.
- Company name listed in the 2024 Conference Exhibitor List, Conference Website, and PRPS Annual Buyers Guide.

RESERVE YOUR BOOTH TODAY!

Contact Niki Tourscher, Director of Training at tour@prps.org

EXPO HALL & ADVERTISING OPTIONS

Expo Hall Booth Information

- Expo Hall fees includes a booth with one skirted 6' x 30" table, folding chair, waste basket, booth id sign. Booth options listed on the next page!
- Deposit is required to secure exhibit space. Payment in full must be received prior to the event.
- Booths are assigned by total conference investment and then in the order that the contract is received. Event Sponsors who invest over \$2,500 will receive preferential selection of booth location, based on availability. All other booth assignments will be made by PRPS staff.
- Booth assignments will begin in January 2024.
- Booth cancellations must be received by PRPS in writing before Friday, February 8, 2024. A \$150 admin fee will be deducted from the refund.

Advertising Opportunities

□ Program Guide Print Ads

Half Page: Inside, Black & White - \$150

Full Page: Inside, Black & White - \$300

Back Cover: Inside, Color - \$500

Full details and specifications at prpsconferencenandexpo.org.
For PRPS year-round advertising, contact Emily S., Director of Communications at eschnellbaugh@prps.org or 814-234-4272.

WHO ATTENDS?

The PA Recreation & Park Society Conference & Expo is the state's exclusive educational and networking event for parks and recreation professionals. Attendance is over 400+ and includes municipal and state recreation managers and directors, leaders of parks systems, maintenance and grounds managers, managers and professionals at all levels of commercial recreation, and citizens/decision makers from parks and recreation boards across the state.

EXHIBIT OPTIONS

<h2>Island Booth</h2> <p>\$2,725/Member</p>	<h2>Prime Booth</h2> <p>\$1,300/Member</p>	<h2>Standard Booth</h2> <p>\$1,000/Member</p>	<h2>Non-Profit Table</h2> <p>\$200</p>
<ul style="list-style-type: none"> • 16' x 20' booth • 6' table & chairs • Booth Signage • 5 Tickets for the following meals: <ul style="list-style-type: none"> ◦ Tues Dinner ◦ Wed. Bfast ◦ Wed. Lunch 	<ul style="list-style-type: none"> • 8' x 10' booth in a PRIME locations • 6' table & chairs • Booth Signage • 2 Tickets for the following meals: <ul style="list-style-type: none"> ◦ Tues Dinner ◦ Wed. Bfast ◦ Wed. Lunch 	<ul style="list-style-type: none"> • 8' x 10' booth • 6' table & chairs • Booth Signage • 2 Tickets for the following meals: <ul style="list-style-type: none"> ◦ Tues Dinner ◦ Wed. Bfast ◦ Wed. Lunch 	<ul style="list-style-type: none"> • 6' table & chairs • Table Sign • 1 Ticket for the following meal: <ul style="list-style-type: none"> ◦ Wed. Lunch
<p>\$2,950 Non-Member *Includes 2024 PRPS Commercial Membership</p>	<p>\$1,525 Non-Member *Includes 2024 PRPS Commercial Membership</p>	<p>\$1,225 Non-Member *Includes 2024 PRPS Commercial Membership</p>	
<p align="center">Extra Booth Rep. Includes three meals, receptions and educational sessions. \$175 (Island, Prime, Standard Booths)</p>			

EXPO HALL LAYOUT

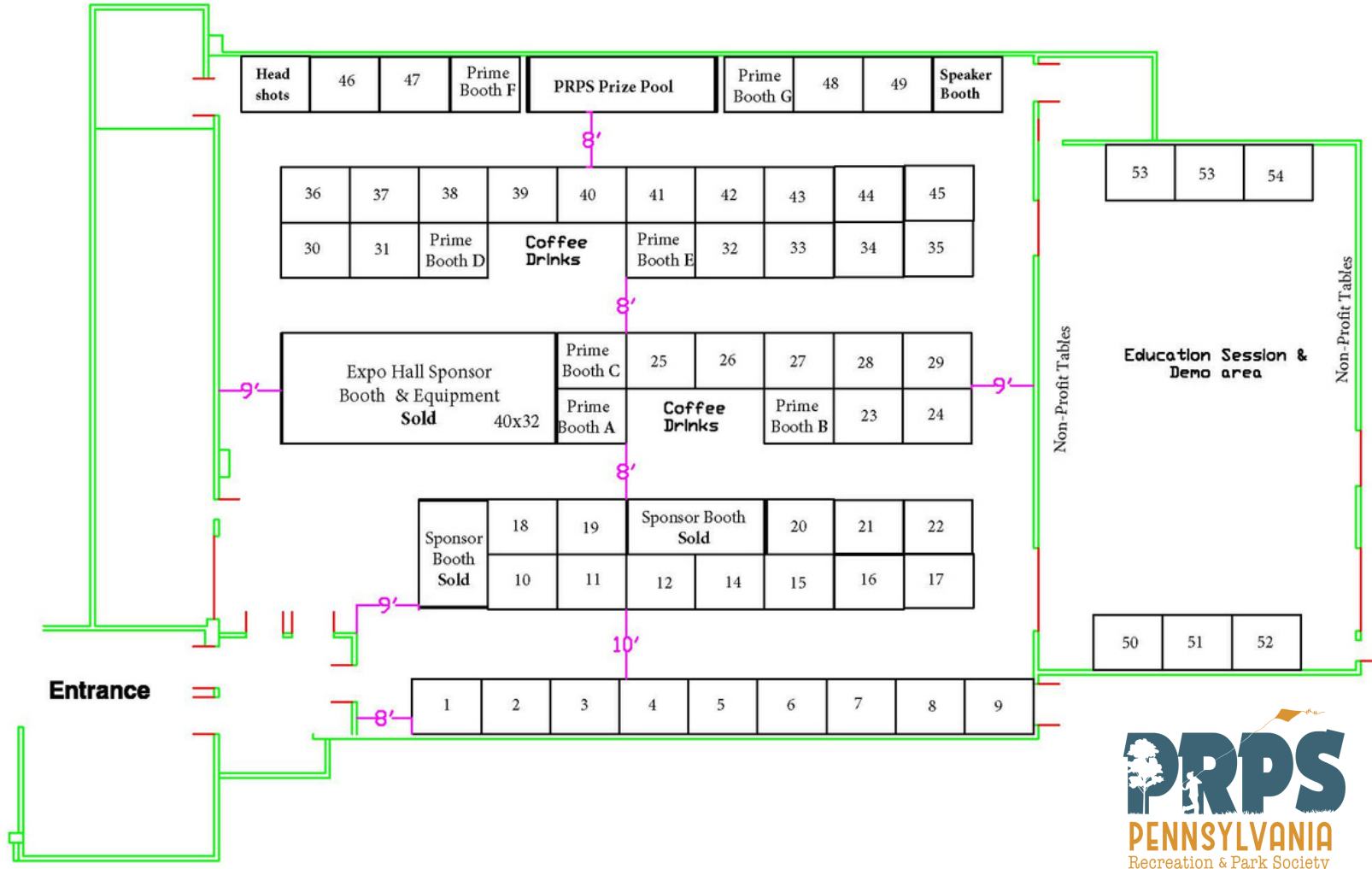

Visit prpsconferenceandexpo.org for full conference details, sponsorship opportunities, and more!